

GENERAL NOTES:

- ALL WORK AND MATERIALS SHALL COMPLY WITH THE 2018 CALTRANS STANDARD PLAN AND SPECIFICATIONS, LATEST EDITION OF STANDARD SPECIFICATIONS FOR PUBLIC WORKS CONSTRUCTION (GREENBOOK), LATEST EDITION OF STANDARD PLANS FOR PUBLIC WORKS CONSTRUCTION, CITY OF GARDEN GROVE STANDARD PLANS, AND THESE PROJECT PLANS, SPECIFICATIONS, AND SPECIAL PROVISIONS.
- THE CONTRACTOR SHALL NOTIFY ALL UTILITY COMPANIES A MINIMUM OF 48 HOURS PRIOR TO START OF CONSTRUCTION. IT SHALL BE THE RESPONSIBILITY OF THE CONTRACTOR TO COORDINATE ALL PHASES OF CONSTRUCTION WITH THE VARIOUS UTILITY COMPANIES INVOLVED.
- THE CONTRACTOR SHALL NOTIFY ALL BUSINESS TENANTS ADJACENT TO THE PROJECT SITE A MINIMUM OF 48 HOURS PRIOR TO THE START OF CONSTRUCTION.
- TRAFFIC CONTROL SHALL CONFORM TO THE TRAFFIC ENGINEERING POLICY TE 32, THE PROVISIONS IN SECTION 7-1.03, "PUBLIC CONVENIENCE" AND SECTION 7-1.04 "PUBLIC SAFETY," OF THE CALTRANS STANDARD SPECIFICATIONS, THE LATEST EDITION OF THE CALIFORNIA MANUAL ON UNIFORM OF TRAFFIC CONTROL DEVICES (CAMUTCD), AND THE LATEST EDITIONS OF WORK AREA TRAFFIC CONTROL HANDBOOK (WATCH MANUAL).
- THE CONTRACTOR SHALL CALL UNDERGROUND SERVICE ALERT (1-800-422-4133 OR 811) THREE WORKING DAYS PRIOR TO DOING ANY EXCAVATION. CONTRACTOR SHALL BE RESPONSIBLE FOR DETERMINING THE LOCATION OF ALL EXISTING UTILITIES AND VERIFY LOCATION AND DEPTH OF ALL UTILITIES WITHIN THE CONSTRUCTION AREA PRIOR TO COMMENCEMENT OF CONSTRUCTION ACTIVITIES. PROTECT IN-PLACE ALL UNDERGROUND AND OVERHEAD UTILITY LINES AND APPURTENANCES. CONTRACTORS SHALL NOTIFY CITY OF ANY POTENTIAL CONFLICT PRIOR TO COMMENCEMENT OF CONSTRUCTION ACTIVITIES.
- THE CONTRACTOR IS RESPONSIBLE TO REMOVE ALL UNDERGROUND SERVICE ALERT PAINT MARKINGS AFTER ALL WORK HAS BEEN COMPLETED.
- CONTRACTOR SHALL MAKE INVENTORY OF, AND PROTECT ALL SURVEY MONUMENTS AND CENTERLINE TIES IN PLACE. CONTRACTOR SHALL TRANSMIT CENTERLINE TIE DOCUMENTS TO THE ORANGE COUNTY SURVEY OFFICE AND THE FIELD ENGINEER, TO VERIFY ALL CENTERLINE TIES HAVE BEEN LOCATED PRIOR TO START OF ANY WORK.
- THE CONTRACTOR SHALL NOTIFY THE FIELD ENGINEER FOR INSPECTION TWO WORKING DAYS PRIOR TO STARTING WORK AT (714) 741-5180.
- PROTECT-IN-PLACE ALL EXISTING IMPROVEMENTS, STRUCTURES, INFRASTRUCTURE, UTILITIES, AND ALL OTHER ITEMS NOT BEING CALLED OUT TO BE REMOVED OR RELOCATED, OR NOT PART OF PROJECT LIMIT. ALL EXISTING IMPROVEMENTS THAT ARE DAMAGED OR REMOVED DURING CONSTRUCTION INCLUDING STRIPING, DRIVEWAYS, CONCRETE CURB & GUTTER, DECORATIVE SIDEWALK, DECORATIVE MONUMENTS/PLOQUES, ACCESS RAMPS, METERS, MANHOLE, VALVES, CLEAN OUTS, UTILITIES, ETC. SHALL BE REPLACED IN KIND, OR AS SPECIFIED IN THE CONTRACT DOCUMENTS.
- THE EDGES OF ALL A.C. PATCHES SHALL BE SEALED WITH ASPHALT EMULSION.
- CONTRACTOR SHALL HAVE SUFFICIENT MATERIALS ON HAND AT ALL TIMES TO EXPEDITE ANY EMERGENCY REPAIR.
- ALL MEASUREMENTS ARE HORIZONTAL. CONTRACTOR IS RESPONSIBLE FOR CONVERTING HORIZONTAL DISTANCES TO SLOPE DISTANCES. CONTRACTOR TO V.I.F. ELEVATIONS & DISPOSE OF EXCESS MATERIALS OFFSITE.
- IF CULTURAL MATERIALS OR RESOURCES ARE DISCOVERED DURING THE PROJECT CONSTRUCTION, ALL WORK IN THE VICINITY OF THE DISCOVERY SHALL IMMEDIATELY CEASE.
- CONTRACTOR SHALL MAINTAIN A SET OF PLANS ON SITE, TRACK ANY APPROVED CHANGES IN A LEGIBLE AND UNDERSTANDABLE FORMAT AND SUBMIT THE FINAL AS-BUILT PLANS TO THE CITY'S PROJECT MANAGER AT PROJECT COMPLETION.
- CONTRACTOR SHALL BE RESPONSIBLE FOR SUBMITTING A SIDEWALK CLOSURE PLAN TO THE CITY FOR APPROVAL.
- CONTRACTOR SHALL BE RESPONSIBLE FOR OBTAINING A CITY ENCROACHMENT PERMIT.
- CONTRACTOR SHALL BE RESPONSIBLE FOR SUBMITTING LOCATIONS FOR THE DIRECTIONAL BORING TO THE CITY FOR APPROVAL.

LIGHTING GENERAL NOTES:

- ALL NEW PULL BOXES SHALL BE NO. 5, 5-T, OR NO. 6 AS NOTED ON THE PLANS.
- ALL CONDUITS SHALL BE SCHEDULE 80 PVC (SIZE AS INDICATED ON PLANS) UNLESS OTHERWISE NOTED ON THE PLANS AND SHALL BE LAID TO A DEPTH OF NOT LESS THAN 30" BELOW THE EXISTING ROADWAY SURFACE AND 18" BELOW THE EXISTING SIDEWALK, UNLESS OTHERWISE SPECIFIED.
- ALL PULL BOXES SHALL CONTAIN A 8" DEEP LAYER OF SMALL ROCKS (3/4" AGGREGATE) AT THE BOTTOM FOR DRAINAGE.
- COORDINATE ALL ELECTRICAL CONNECTIONS WITH SOUTHERN CALIFORNIA EDISON (S.C.E.). CONTACT S.C.E. SERVICE PLANNER TRAVIS HENNESSY AT (714) 285-4339 PRIOR TO START WORK.
- CONDUCTORS SHALL BE STRANDED COPPER CONDUCTOR, TYPE THWN/THHN INSULATION, UL APPROVED FOR 600 VOLT OPERATION UNLESS OTHERWISE SPECIFIED HEREON.
- WARNING: SAFETY CLEARANCE SHALL BE OBTAINED DAILY FROM THE AFFECTED UTILITY COMPANY BEFORE DOING ANY WORK WITHIN CLOSE PROXIMITY TO ANY OVERHEAD OR UNDERGROUND UTILITY LINE.
- ALL DECORATIVE SIDEWALK SHALL BE PROTECTED IN PLACE.
- ALL STAMPED, COLORED CONCRETE SHALL BE REPAIRED AND REPLACED IN-KIND PER CITY OF GARDEN GROVE SPECIFICATIONS.
- DECORATIVE MONUMENTS/PLOQUES IN SIDEWALK SHALL BE PROTECTED IN PLACE.
- CONTRACTOR SHALL INSTALL CONDUIT TO ELECTRICAL BOXES AND/OR ENCLOSURES USING NECESSARY EQUIPMENT/MATERIALS TO ENSURE A SECURE, TIGHT AND WATERPROOF CONNECTION.
- CONTRACTOR SHALL MODIFY ELECTRICAL BOXES AND/OR ENCLOSURES AS NECESSARY TO INSTALL CONDUIT TO THE SATISFACTION OF THE FIELD ENGINEER.
- CONTRACTOR SHALL INSTALL 3/4" GALVANIZED STEEL CONDUIT AS SUPPORTING ROD AT ELECTRICAL BOXES AND/OR ENCLOSURES AT THE END OF THE CIRCUIT TO STABILIZE ELECTRICAL BOX.
- CONTRACTOR SHALL INSTALL 3/4" FLEXIBLE WATERTIGHT CONDUIT FROM ELECTRICAL BOXES AND/OR ENCLOSURES TO WRAP AROUND THE BASE OF EXISTING TREES FOR 2- FEET TO PREVENT WATER FROM ENTERING ELECTRICAL BOX.
- CONTRACTOR SHALL INSTALL CONDUIT BY TRENCHING UNLESS OTHERWISE NOTED ON THE PLANS.
- ALL OUTLETS SHALL BE CLEARLY LABELED WITH THE CIRCUIT NUMBER.
- CONDUIT SHALL NOT BE PLACED CLOSER THAN 5' FROM EXISTING WATER LINES.

CAUTION: THE ENGINEER OF RECORD WILL NOT BE RESPONSIBLE FOR OR LIABLE FOR ANY UNAUTHORIZED CHANGES TO THESE PLANS. ALL CHANGES MUST BE APPROVED BY THE PLAN PREPARER.

Underground Service Alert



Know what's below. Call before you dig.

CALL 811 TWO WORKING DAYS BEFORE YOU DIG.

DESIGNED BY:	DRAWN BY:	CHECKED BY:	REVISIONS				
S.L.	S.L.	E.O.	REV.	DATE	DESCRIPTION	ISSUED BY	APP'D
PLANS PREPARED UNDER THE SUPERVISION OF:			0				
ANASTASIA SANCHEZ, P.E.			1				
R.C.E. No. CB6541			2				
			3				



City Of Garden Grove

MAIN STREET ELECTRICAL IMPROVEMENTS PROJECT

MAIN STREET FROM ACACIA PARKWAY TO GARDEN GROVE BOULEVARD

PROJECT No. CP GGCF MSLI 001-2021

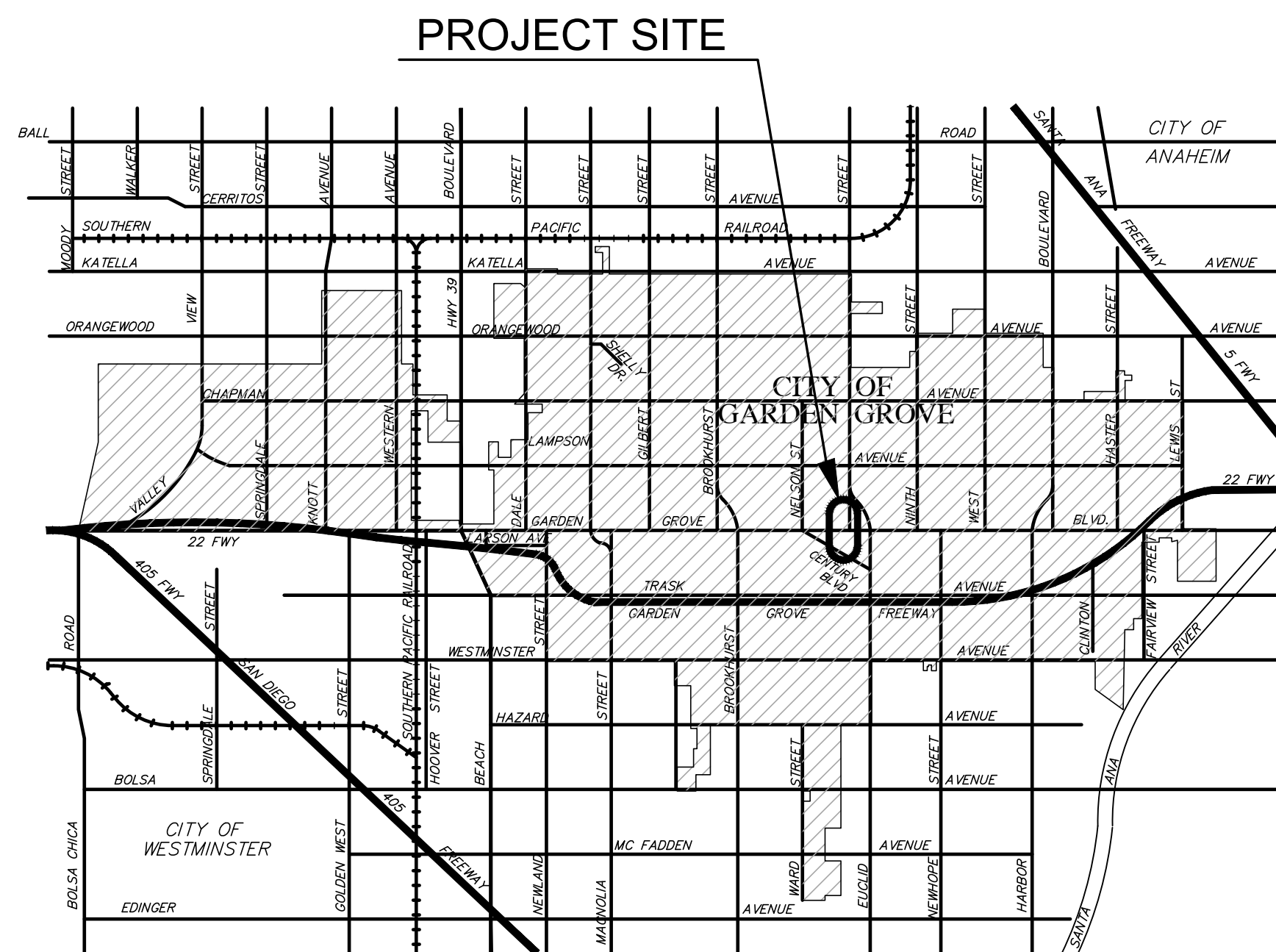

LOCATION MAP
NOT TO SCALE

CONSTRUCTION NOTES:

- PROTECT EXISTING SERVICE CABINET WITH 1-120/240V SERVICE METER AND 1-200 AMP-1P MAIN CIRCUIT BREAKER. SEE SHEET 3 FOR EXISTING AND PROPOSED CIRCUIT BREAKERS. SEE DETAIL "D" ON SHEET 2 FOR MODIFICATIONS TO SERVICE CABINET.
- NOT IN USE.
- INSTALL NO. 5 PULL BOX.
- INSTALL NO. 5-T PULL BOX.
- INSTALL NO. 6 PULL BOX.
- INSTALL 3/4" GALVANIZED RIGID STEEL CONDUIT WITH 2#12 (1-RED, 1-WHITE) FOR TREE LIGHTING, 1#12 GROUND (1-GREEN) AND PULL ROPE.
- INSTALL 3/4" GALVANIZED RIGID STEEL CONDUIT AS SUPPORTING ROD.
- INSTALL 3" CONDUIT WITH 16#8 (8-BLACK, 8-WHITE) FOR GFCI OUTLETS, 16#8 (8-RED, 8-WHITE) FOR TREE LIGHTING, 1#12 GROUND (1-GREEN) AND PULL ROPE.
- INSTALL 150' LENGTH, 3/4" LED WARM WHITE ROPE LIGHT WRAPPED AROUND EXISTING TREE. TREE WRAPPING SHALL BE EVERY 0.5- FEET. ANY EXCESS ROPE LIGHT SHALL BE CUT OFF AND SEALED PER MANUFACTURER'S SPECIFICATIONS. SEE DETAIL "A" AND "B" ON SHEET 2.
- INSTALL BELL #5330-0 WEATHERPROOF ELECTRICAL BOX. CONTRACTOR SHALL HARDWIRE TREE LIGHTING IN BOX. BOX SHALL BE LOCATED CLOSEST TO EXISTING TREES AS POSSIBLE ON THE STREET SIDE. SEE DETAIL "A" ON SHEET 2.
- INSTALL L-COM #NB121005-100 120 VAC WEATHERPROOF ENCLOSURE WITH MOUNTING PLATE AND STANDARD SURGE PROTECTED, DUPLEX 120 VAC OUTLET. CONTRACTOR SHALL HARDWIRE TREE LIGHTING IN BOX. BOX SHALL BE LOCATED CLOSEST TO EXISTING TREES AS POSSIBLE ON THE STREET SIDE. SEE DETAIL "B" ON SHEET 2.
- INSTALL BELL #5330-0 WEATHERPROOF ELECTRICAL BOX WITH DUPLEX RECEPTACLE GFCI OUTLET AND INTERMATIC WEATHERPROOF PADLOCKABLE COVER #WP3110MXD. CONTRACTOR SHALL INSTALL BOX TO EXISTING STREET LIGHT POLE WITH SCREWS. SEE DETAIL "C" ON SHEET 2.
- INSTALL PHOTOELECTRIC CELL AND 4-POLE CONTACTOR FOR TREE LIGHT CIRCUITS.
- INSTALL 2" CONDUIT WITH 4#8 (2-BLACK, 2-WHITE) FOR GFCI OUTLETS, 1#12 GROUND (1-GREEN) AND PULL ROPE BY JACKING & BORING..
- INSTALL 3" CONDUIT WITH 8#8 (4-BLACK, 4-WHITE) FOR GFCI OUTLETS, 8#8 (4-RED, 4-WHITE) FOR TREE LIGHTING, 1#12 GROUND (1-GREEN) AND PULL ROPE BY JACKING & BORING.
- INSTALL 2" CONDUIT WITH 4#8 (2-BLACK, 2-WHITE) FOR GFCI OUTLETS, 4#8 (2-RED, 2-WHITE) FOR TREE LIGHTING, 1#12 GROUND (1-GREEN) AND PULL ROPE.
- INSTALL 3/4" GALVANIZED RIGID STEEL CONDUIT WITH 2#12 (1-BLACK, 1-WHITE) FOR GFCI OUTLETS, 2#12 (1-RED, 1-WHITE) FOR TREE LIGHTING, 1#12 GROUND (1-GREEN) AND PULL ROPE.
- INSTALL 3/4" GALVANIZED RIGID STEEL CONDUIT WITH 2#12 (1-BLACK, 1-WHITE) FOR GFCI OUTLETS, 1#12 GROUND (1-GREEN) AND PULL ROPE.
- INSTALL 2" CONDUIT WITH 4#8 (2-BLACK, 2-WHITE) FOR GFCI OUTLETS, 4#8 (2-RED, 2-WHITE) FOR TREE LIGHTING, 1#12 GROUND (1-GREEN) AND PULL ROPE BY JACKING & BORING.
- REMOVE EXISTING 6" CONCRETE RIBBON AND SAWCUT 6" OF EXISTING STAMPED CONCRETE FOR 12" WIDE TRENCH. CONSTRUCT 6" THICK, 1' WIDTH PCC PAVEMENT (3250 PSI) OVER 6" C.A.B. OVER EXISTING SUBGRADE COMPACTED TO 95% RELATIVE COMPACTION. CONCRETE SHALL HAVE LIGHT BROOM FINISH. REINFORCE WITH #4 REBAR AT 24" O.C., 12" LENGTH (TO EXISTING CONCRETE PAVEMENT) AND #4 REBAR RUNNING ENTIRE LENGTH OF THE CONCRETE.
- INSTALL PULL BOX IN EXISTING CONDUIT RUN.
- PROTECT EXISTING IN PLACE.

UTILITY CONTACT INFORMATION

UTILITY	CONTACT	PHONE NO.
GARDEN GROVE SEWER DIVISION	BRENT HAYES	(714) 741-5976
GARDEN GROVE WATER DIVISION	CARINA DAN	(714) 741-5346
GARDEN GROVE TRAFFIC DIVISION	DAI VU	(714) 741-5189
SOUTHERN CALIFORNIA EDISON CO.	TRAVIS HENNESSY	(714) 285-4339
THE GAS CO.	RYAN LOPEZ	(714) 634-3213
AT&T	YVETTE MARTINEZ-GARAFANO	(714) 666-5692
O.C.T.A.	JEROME JOHNSON	(714) 265-4365
TIME WARNER COMMUNICATIONS	CURTIS VASQUEZ	(714) 719-7880
COUNTY SANITATION DISTRICT OF O.C.	DANIEL LEE	(714) 593-7176
VERIZON	MIKE MADRID	(714) 375-6720

SHEET INDEX		
SHEET NO.	SHEET TITLE	STREET NAME
1	TITLE SHEET	---
2	DETAIL SHEET	---
3	STREET LIGHTING PLANS	MAIN STREET

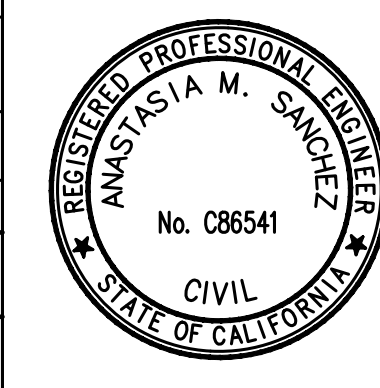

AS
ANASTASIA SANCHEZ, P.E.

6/24/2022
DATE

MAIN STREET ELECTRICAL IMPROVEMENTS PROJECT

TITLE SHEET

DRAWING NUMBER

SHEET 1 OF 3

MAIN STREET ELECTRICAL IMPROVEMENTS PROJECT, PROJ No. CP GGCF MSLI 001-2021

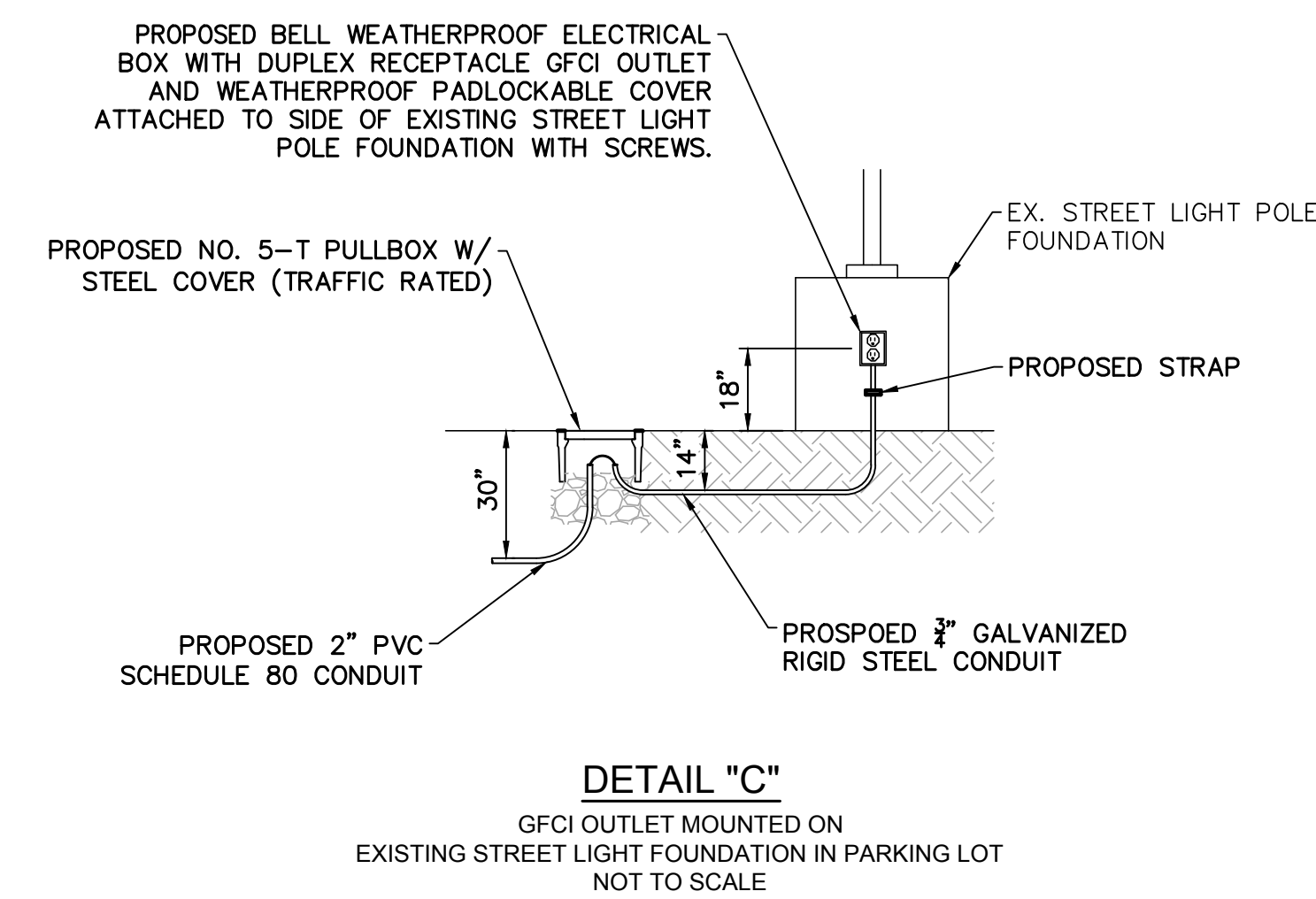
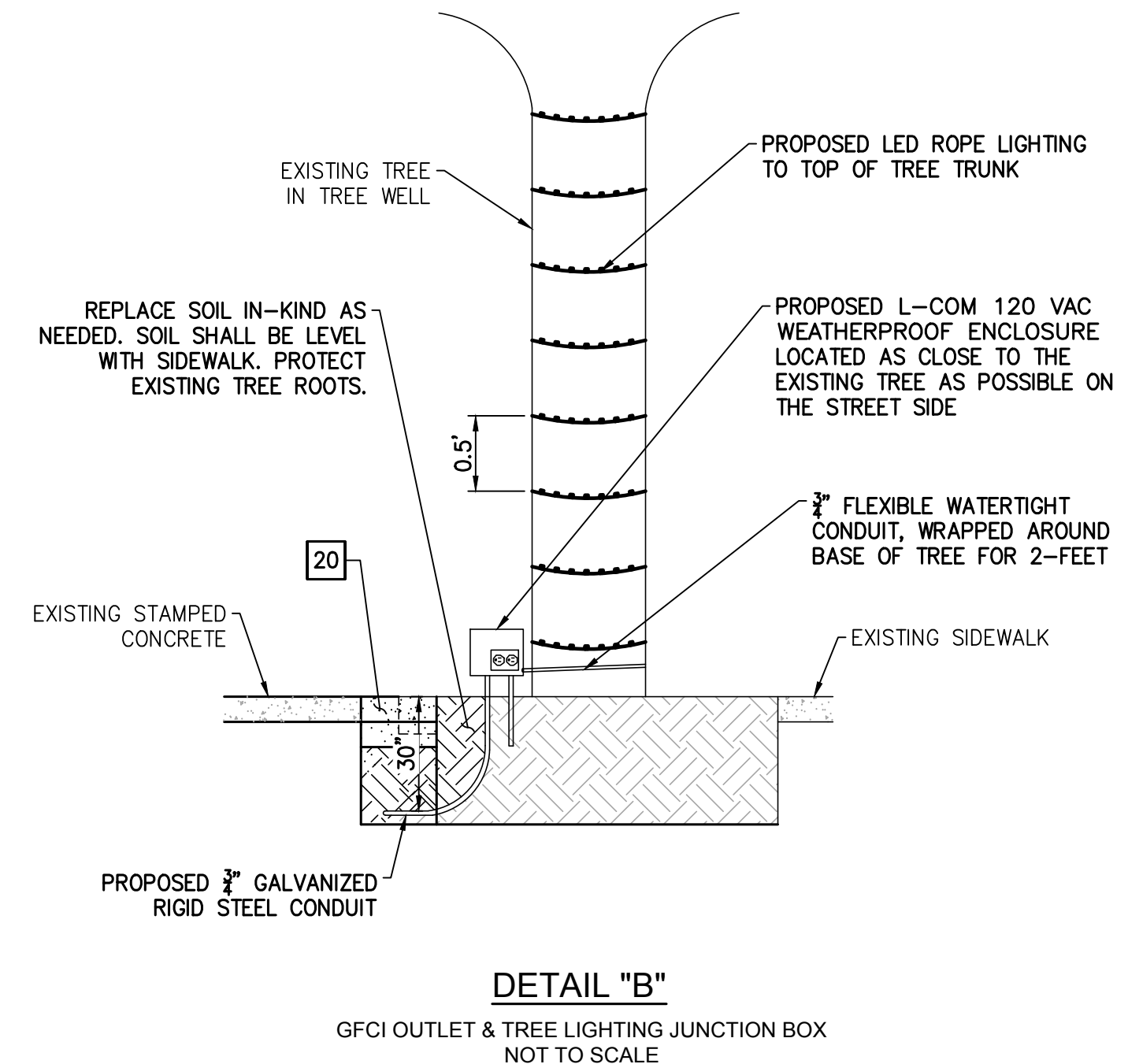
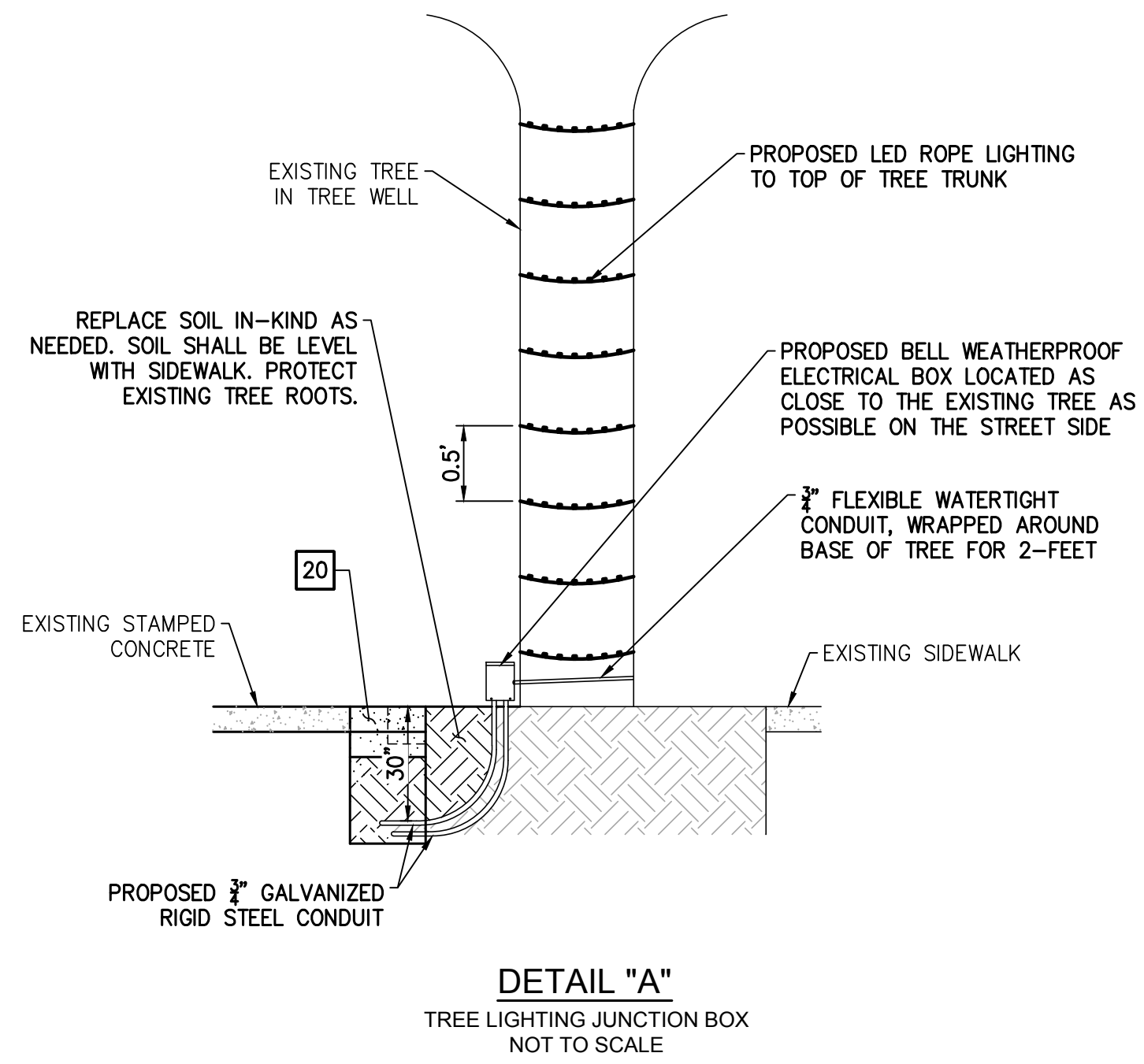

CONSTRUCTION NOTES:

- 1 PROTECT EXISTING SERVICE CABINET WITH 1-120/240V SERVICE METER AND 1-200 AMP-1P MAIN CIRCUIT BREAKER. SEE SHEET 3 FOR EXISTING AND PROPOSED CIRCUIT BREAKERS. SEE DETAIL "D" ON SHEET 2 FOR MODIFICATIONS TO SERVICE CABINET.
- 2 NOT IN USE.
- 3 INSTALL NO. 5 PULL BOX.
- 4 INSTALL NO. 5-T PULL BOX.
- 5 INSTALL NO. 6 PULL BOX.
- 6 INSTALL 3/4" GALVANIZED RIGID STEEL CONDUIT WITH 2#12 (1-RED, 1-WHITE) FOR TREE LIGHTING, 1#12 GROUND (1-GREEN) AND PULL ROPE.
- 7 INSTALL 3/4" GALVANIZED RIGID STEEL CONDUIT AS SUPPORTING ROD.
- 8 INSTALL 3" CONDUIT WITH 16#8 (8-BLACK, 8-WHITE) FOR GFCI OUTLETS, 16#8 (8-RED, 8-WHITE) FOR TREE LIGHTING, 1#12 GROUND (1-GREEN) AND PULL ROPE.
- 9 INSTALL 150' LENGTH, 3/8" LED WARM WHITE ROPE LIGHT WRAPPED AROUND EXISTING TREE. TREE WRAPPING SHALL BE EVERY 0.5- FEET. ANY EXCESS ROPE LIGHT SHALL BE CUT OFF AND SEALED PER MANUFACTURER'S SPECIFICATIONS. SEE DETAIL "A" AND "B" ON SHEET 2.
- 10 INSTALL BELL #5330-0 WEATHERPROOF ELECTRICAL BOX. CONTRACTOR SHALL HARDWIRE TREE LIGHTING IN BOX. BOX SHALL BE LOCATED CLOSEST TO EXISTING TREES AS POSSIBLE ON THE STREET SIDE. SEE DETAIL "A" ON SHEET 2.
- 11 INSTALL L-COM #NB121005-100 120 VAC WEATHERPROOF ENCLOSURE WITH MOUNTING PLATE AND STANDARD SURGE PROTECTED, DUPLEX 120 VAC OUTLET. CONTRACTOR SHALL HARDWIRE TREE LIGHTING IN BOX. BOX SHALL BE LOCATED CLOSEST TO EXISTING TREES AS POSSIBLE ON THE STREET SIDE. SEE DETAIL "B" ON SHEET 2.
- 12 INSTALL BELL #5330-0 WEATHERPROOF ELECTRICAL BOX WITH DUPLEX RECEPTACLE GFCI OUTLET AND INTERMATIC WEATHERPROOF PADLOCKABLE COVER #WP3110MXD. CONTRACTOR SHALL INSTALL BOX TO EXISTING STREET LIGHT POLE WITH SCREWS. SEE DETAIL "C" ON SHEET 2.
- 13 INSTALL PHOTOELECTRIC CELL AND 4-POLE CONTACTOR FOR TREE LIGHT CIRCUITS.
- 14 INSTALL 2" CONDUIT WITH 4#8 (2-BLACK, 2-WHITE) FOR GFCI OUTLETS, 1#12 GROUND (1-GREEN) AND PULL ROPE BY JACKING & BORING.
- 15 INSTALL 3" CONDUIT WITH 8#8 (4-BLACK, 4-WHITE) FOR GFCI OUTLETS, 8#8 (4-RED, 4-WHITE) FOR TREE LIGHTING, 1#12 GROUND (1-GREEN) AND PULL ROPE BY JACKING & BORING.
- 16 INSTALL 2" CONDUIT WITH 4#8 (2-BLACK, 2-WHITE) FOR GFCI OUTLETS, 4#8 (2-RED, 2-WHITE) FOR TREE LIGHTING, 1#12 GROUND (1-GREEN) AND PULL ROPE.
- 17 INSTALL 3/4" GALVANIZED RIGID STEEL CONDUIT WITH 2#12 (1-BLACK, 1-WHITE) FOR GFCI OUTLETS, 2#12 (1-RED, 1-WHITE) FOR TREE LIGHTING, 1#12 GROUND (1-GREEN) AND PULL ROPE.
- 18 INSTALL 3/4" GALVANIZED RIGID STEEL CONDUIT WITH 2#12 (1-BLACK, 1-WHITE) FOR GFCI OUTLETS, 1#12 GROUND (1-GREEN) AND PULL ROPE.
- 19 INSTALL 2" CONDUIT WITH 4#8 (2-BLACK, 2-WHITE) FOR GFCI OUTLETS, 4#8 (2-RED, 2-WHITE) FOR TREE LIGHTING, 1#12 GROUND (1-GREEN) AND PULL ROPE BY JACKING & BORING.
- 20 REMOVE EXISTING 6" CONCRETE RIBBON AND SAWCUT 6" OF EXISTING STAMPED CONCRETE FOR 12" WIDE TRENCH. CONSTRUCT 6" THICK, 1' WIDTH PCC PAVEMENT (3250 PSI) OVER 6" C.A.B. OVER EXISTING SUBGRADE COMPACTED TO 95% RELATIVE COMPACTION. CONCRETE SHALL HAVE LIGHT BROOM FINISH. REINFORCE WITH #4 REBAR AT 24" O.C., 12" LENGTH (TO EXISTING CONCRETE PAVEMENT) AND #4 REBAR RUNNING ENTIRE LENGTH OF THE CONCRETE.
- BC INSTALL PULL BOX IN EXISTING CONDUIT RUN.
- PP PROTECT EXISTING IN PLACE.

EQUIPMENT SCHEDULE

SYMBOL	QUANTITY	DESCRIPTION	MANUFACTURER/CATALOG NUMBER	
			LUMINAIRE/LAMP	
	1	NO. 6 FIBERLYTE PULL BOX, OLD CASTLE OR AGENCY APPROVED EQUAL.	OLD CASTLE / FIBRELYTE FL36	
	6	NO. 5 FIBERLYTE PULL BOX, OLD CASTLE OR AGENCY APPROVED EQUAL.	OLD CASTLE / FIBRELYTE FL30	
	1	NO. 5-T STEEL COVER PULL BOX WITH BOLT DOWN LID, BROOKS PRODUCTS OR APPROVED EQUAL.	BROOKS PRODUCTS / NO. 5-T PB	
	33	LED WARM WHITE ROPE LIGHT.	AMERICAN LIGHTING / 3/8" CLEAR TUBING WITH WARM WHITE LEDS 120 VOLT, 150 FT	
	27	BELL WEATHERPROOF ELECTRICAL BOX WITH WEATHERPROOF COVER.	GRAINGER / WEATHERPROOF ELECTRICAL BOX NO# 5330-0 GRAINGER / WEATHERPROOF COVER NO# 5173-0	
	8	L-COM 120 VAC WEATHERPROOF ENCLOSURE WITH MOUNTING PLATE AND STANDARD SURGE PROTECTED, DUPLEX 120 VAC OUTLET.	L-COM NEMA TYPE 4, 4X/ IP66 RATED NO# NB121005-100	
	2	BELL WEATHERPROOF ELECTRICAL BOX WITH DUPLEX RECEPTACLE GFCI OUTLET AND WEATHERPROOF PADLOCKABLE COVER BY INTERMATIC #WP3110MXD.	GRAINGER / WEATHERPROOF ELECTRICAL BOX NO# 5330-0 INTERMATIC / WEATHERPROOF COVER #WP3110MXD	
	1050'	3/4" GALVANIZED RIGID STEEL CONDUIT. ENDS OF CONDUITS TERMINATING IN PULL BOXES SHALL BE SUPPLIED WITH SWEEPS AND BUSHINGS. CIRCUIT TYPE COLORS: TREE LIGHT-RED, GFCI OUTLET-BLACK. NUMBER OF CONDUCTORS AS INDICATED.		
	750'	NEW 2" PVC SCHEDULE 80 CONDUIT.		
	100'	NEW 3" PVC SCHEDULE 80 CONDUIT.		
	70'	NEW 3/4" FLEXIBLE WATERTIGHT CONDUIT.		

LIGHTING EQUIPMENT NOTES:
 1. INSTALL EQUIPMENT PER MANUFACTURERS INSTRUCTIONS.
 2. CONTRACTOR SHALL PROVIDE ALL LAMPS, ACCESSORIES AND MOUNTING HARDWARE AS REQUIRED.
 3. CONTRACTOR SHALL VERIFY EXACT FIXTURE BY MANUFACTURER SPECIFIED OR APPROVED EQUAL SUBSTITUTED FIXTURES WILL REQUIRE PHOTOMETRIC CALCULATIONS AND MUST PERFORM EQUAL TO OR BETTER THAN LIGHT FIXTURE SPECIFIED. ENGINEER TO MAKE FINAL DETERMINATION.
 4. PHOTO ELECTRIC CELL BY OTHERS

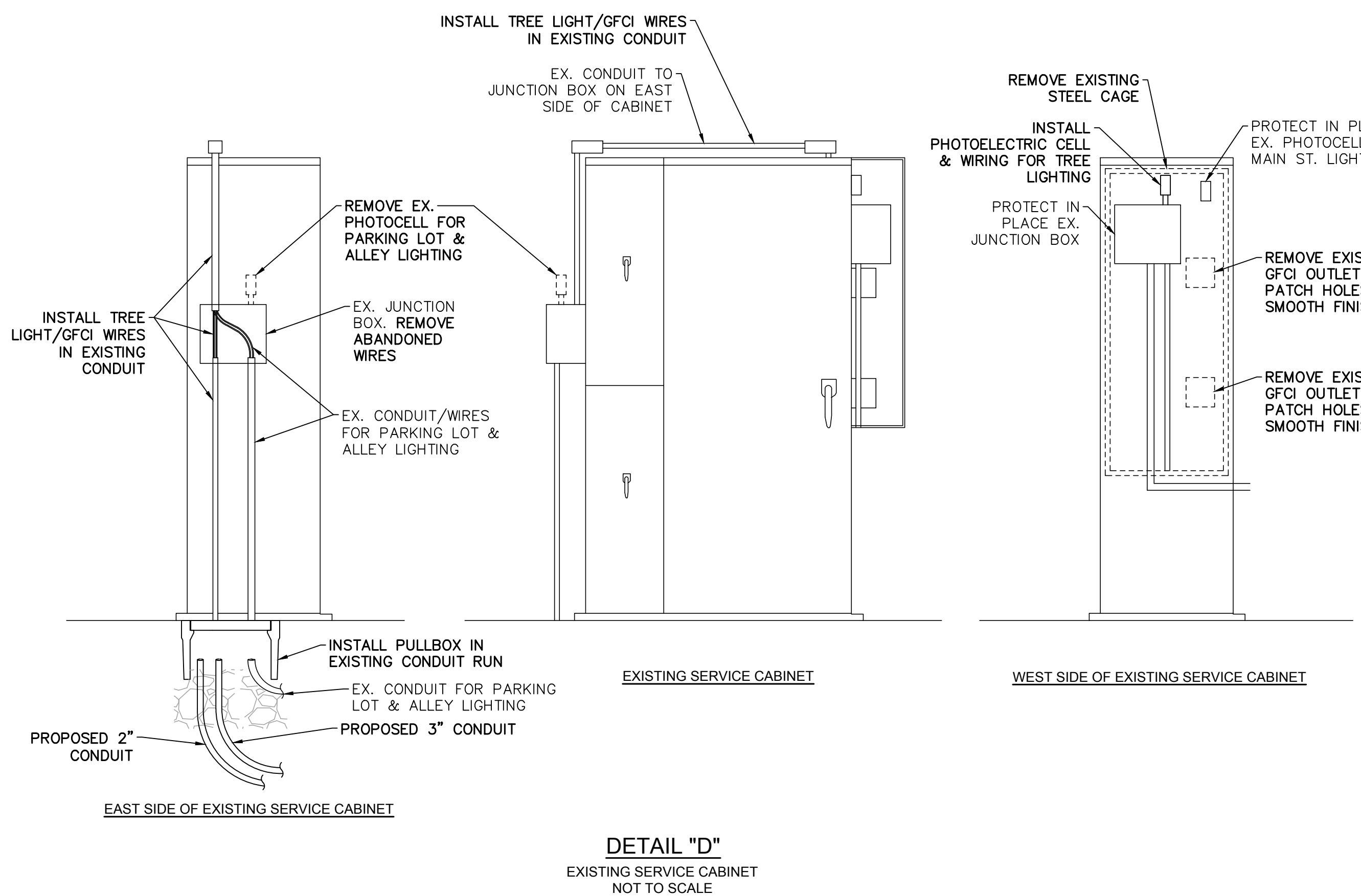

LEGEND

- EXISTING SERVICE CABINET.
- EXISTING STREET LIGHTING PULL BOX TO REMAIN.
- PROPOSED NO. 6 STREET LIGHT PULL BOX. SEE LIGHTING EQUIPMENT SCHEDULE.
- PROPOSED NO. 5 STREET LIGHTING PULL BOX. SEE LIGHTING EQUIPMENT SCHEDULE.
- PROPOSED NO. 5-T STREET LIGHTING PULL BOX (TRAFFIC GRADE). SEE LIGHTING EQUIPMENT SCHEDULE.
- EXISTING STREET LIGHTING PULL BOX TO BE REMOVED.
- EXISTING STREET LIGHT TO REMAIN.
- EXISTING HIGHWAY SAFETY LIGHTING (HSL) ON TRAFFIC SIGNAL STANDARD.
- PROPOSED L-COM 120 VAC WEATHERPROOF ENCLOSURE WITH MOUNTING PLATE AND STANDARD SURGE PROTECTED, DUPLEX 120 VAC OUTLET.
- PROPOSED BELL WEATHERPROOF ELECTRICAL BOX WITH DUPLEX RECEPTACLE GFCI OUTLET AND WEATHERPROOF PADLOCKABLE COVER.
- EXISTING TREE WITH PROPOSED LED ROPE LIGHTING.
- PROPOSED BELL WEATHERPROOF ELECTRICAL BOX.
- EXISTING 1.5" CONDUIT TO REMAIN.
- EXISTING 2" CONDUIT TO REMAIN.
- PROPOSED 3/4" GALVANIZED RIGID STEEL CONDUIT. SEE EQUIPMENT SCHEDULE.
- PROPOSED 2" CONDUIT. SEE EQUIPMENT SCHEDULE.
- PROPOSED 3" CONDUIT. SEE EQUIPMENT SCHEDULE.
- NUMBER OF EXISTING TREES.

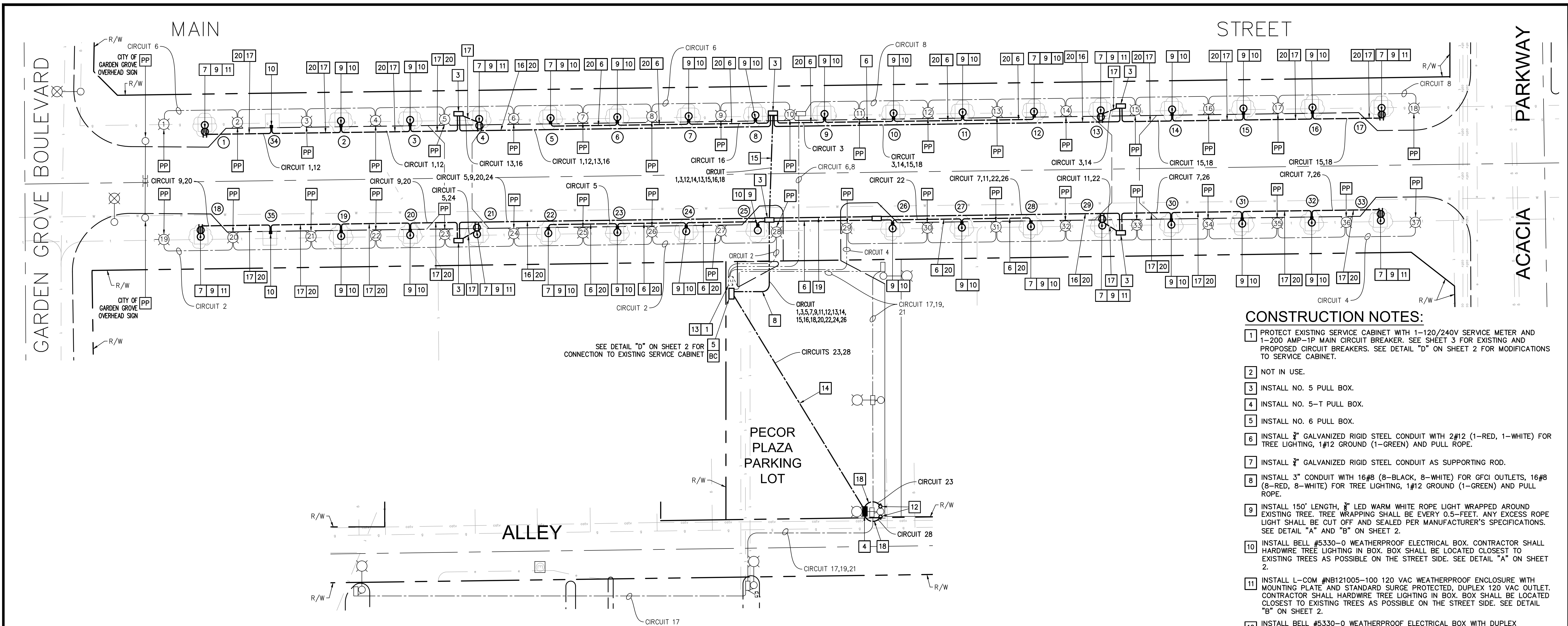

SEE DETAIL "D" ON SHEET 2 FOR CONNECTION TO EXISTING SERVICE CABINET

CONSTRUCTION NOTES:

- 1 PROTECT EXISTING SERVICE CABINET WITH 1-120/240V SERVICE METER AND 1-200 AMP-1P MAIN CIRCUIT BREAKER. SEE SHEET 3 FOR EXISTING AND PROPOSED CIRCUIT BREAKERS. SEE DETAIL "D" ON SHEET 2 FOR MODIFICATIONS TO SERVICE CABINET.
- 2 NOT IN USE.
- 3 INSTALL NO. 5 PULL BOX.
- 4 INSTALL NO. 5-T PULL BOX.
- 5 INSTALL NO. 6 PULL BOX.
- 6 INSTALL 3/4" GALVANIZED RIGID STEEL CONDUIT WITH 2#12 (1-RED, 1-WHITE) FOR TREE LIGHTING, 1#12 GROUND (1-GREEN) AND PULL ROPE.
- 7 INSTALL 3/4" GALVANIZED RIGID STEEL CONDUIT AS SUPPORTING ROD.
- 8 INSTALL 3" CONDUIT WITH 16#8 (8-BLACK, 8-WHITE) FOR GFCI OUTLETS, 16#8 (8-RED, 8-WHITE) FOR TREE LIGHTING, 1#12 GROUND (1-GREEN) AND PULL ROPE.
- 9 INSTALL 150' LENGTH, 3/4" LED WARM WHITE ROPE LIGHT WRAPPED AROUND EXISTING TREE. TREE WRAPPING SHALL BE EVERY 0.5- FEET. ANY EXCESS ROPE LIGHT SHALL BE CUT OFF AND SEALED PER MANUFACTURER'S SPECIFICATIONS. SEE DETAIL "A" AND "B" ON SHEET 2.
- 10 INSTALL BELL #5330-0 WEATHERPROOF ELECTRICAL BOX. CONTRACTOR SHALL HARDWIRE TREE LIGHTING IN BOX. BOX SHALL BE LOCATED CLOSEST TO EXISTING TREES AS POSSIBLE ON THE STREET SIDE. SEE DETAIL "A" ON SHEET 2.
- 11 INSTALL L-COM #NB121005-100 120 VAC WEATHERPROOF ENCLOSURE WITH MOUNTING PLATE AND STANDARD SURGE PROTECTED, DUPLEX 120 VAC OUTLET. CONTRACTOR SHALL HARDWIRE TREE LIGHTING IN BOX. BOX SHALL BE LOCATED CLOSEST TO EXISTING TREES AS POSSIBLE ON THE STREET SIDE. SEE DETAIL "B" ON SHEET 2.
- 12 INSTALL BELL #5330-0 WEATHERPROOF ELECTRICAL BOX WITH DUPLEX RECEPTACLE GFCI OUTLET AND INTERMATIC WEATHERPROOF PADLOCKABLE COVER #WP3110MXD. CONTRACTOR SHALL INSTALL BOX TO EXISTING STREET LIGHT POLE WITH SCREWS. SEE DETAIL "C" ON SHEET 2.
- 13 INSTALL PHOTOELECTRIC CELL AND 4-POLE CONTACTOR FOR TREE LIGHT CIRCUITS.
- 14 INSTALL 2" CONDUIT WITH 4#8 (2-BLACK, 2-WHITE) FOR GFCI OUTLETS, 1#12 GROUND (1-GREEN) AND PULL ROPE BY JACKING & BORING.
- 15 INSTALL 3" CONDUIT WITH 8#8 (4-BLACK, 4-WHITE) FOR GFCI OUTLETS, 8#8 (4-RED, 4-WHITE) FOR TREE LIGHTING, 1#12 GROUND (1-GREEN) AND PULL ROPE BY JACKING & BORING.
- 16 INSTALL 2" CONDUIT WITH 4#8 (2-BLACK, 2-WHITE) FOR GFCI OUTLETS, 4#8 (2-RED, 2-WHITE) FOR TREE LIGHTING, 1#12 GROUND (1-GREEN) AND PULL ROPE.
- 17 INSTALL 3/4" GALVANIZED RIGID STEEL CONDUIT WITH 2#12 (1-BLACK, 1-WHITE) FOR GFCI OUTLETS, 2#12 (1-RED, 1-WHITE) FOR TREE LIGHTING, 1#12 GROUND (1-GREEN) AND PULL ROPE.
- 18 INSTALL 3/4" GALVANIZED RIGID STEEL CONDUIT WITH 2#12 (1-BLACK, 1-WHITE) FOR GFCI OUTLETS, 1#12 GROUND (1-GREEN) AND PULL ROPE.
- 19 INSTALL 2" CONDUIT WITH 4#8 (2-BLACK, 2-WHITE) FOR GFCI OUTLETS, 4#8 (2-RED, 2-WHITE) FOR TREE LIGHTING, 1#12 GROUND (1-GREEN) AND PULL ROPE BY JACKING & BORING.
- 20 REMOVE EXISTING 6" CONCRETE RIBBON AND SAWCUT 6" OF EXISTING STAMPED CONCRETE FOR 12" WIDE TRENCH. CONSTRUCT 6" THICK, 1" WIDTH PCC PAVEMENT (3250 PSI) OVER 6" C.A.B. OVER EXISTING SUBGRADE COMPACTED TO 95% RELATIVE COMPACTION. CONCRETE SHALL HAVE LIGHT BROOM FINISH. REINFORCE WITH #4 REBAR AT 24" O.C., 12" LENGTH (TO EXISTING CONCRETE PAVEMENT) AND #4 REBAR RUNNING ENTIRE LENGTH OF THE CONCRETE.
- BC INSTALL PULL BOX IN EXISTING CONDUIT RUN.
- PP PROTECT EXISTING IN PLACE.

LEGEND

- EXISTING SERVICE CABINET.
- EXISTING STREET LIGHTING PULL BOX TO REMAIN.
- PROPOSED NO. 6 STREET LIGHT PULL BOX. SEE LIGHTING EQUIPMENT SCHEDULE.
- PROPOSED NO. 5 STREET LIGHTING PULL BOX. SEE LIGHTING EQUIPMENT SCHEDULE.
- PROPOSED NO. 5-T STREET LIGHTING PULL BOX (TRAFFIC GRADE). SEE LIGHTING EQUIPMENT SCHEDULE.
- EXISTING STREET LIGHTING PULL BOX TO BE REMOVED.
- EXISTING STREET LIGHT TO REMAIN.
- EXISTING HIGHWAY SAFETY LIGHTING (HSL) ON TRAFFIC SIGNAL STANDARD.
- PROPOSED L-COM 120 VAC WEATHERPROOF ENCLOSURE WITH MOUNTING PLATE AND STANDARD SURGE PROTECTED, DUPLEX 120 VAC OUTLET.
- PROPOSED BELL WEATHERPROOF ELECTRICAL BOX WITH DUPLEX RECEPTACLE GFCI OUTLET AND WEATHERPROOF PADLOCKABLE COVER.
- EXISTING TREE WITH PROPOSED LED ROPE LIGHTING.
- PROPOSED BELL WEATHERPROOF ELECTRICAL BOX.
- EXISTING 1.5" CONDUIT TO REMAIN.
- EXISTING 2" CONDUIT TO REMAIN.
- PROPOSED 3/4" GALVANIZED RIGID STEEL CONDUIT. SEE EQUIPMENT SCHEDULE.
- PROPOSED 2" CONDUIT. SEE EQUIPMENT SCHEDULE.
- PROPOSED 3" CONDUIT. SEE EQUIPMENT SCHEDULE.
- NUMBER OF EXISTING TREES.

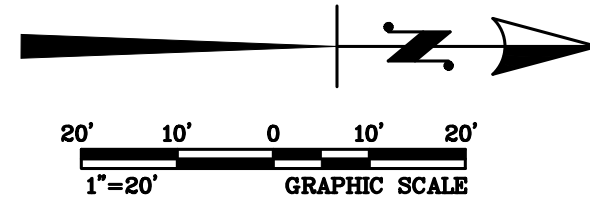

SERVICE					
CIRCUIT	TYPE	CONDUCTORS	CIRCUIT BREAKER	LOAD	EQUIPMENT
1	TREE LIGHTS (1-3, 34)	2#12 1-RED, 1-WHITE	20A-120-1P	300W	3-100W TREE LIGHTS
3	TREE LIGHTS (9-13)	2#12 1-RED, 1-WHITE	20A-120-1P	500W	5-100W TREE LIGHTS
5	TREE LIGHTS (21-25)	2#12 1-RED, 1-WHITE	20A-120-1P	500W	5-100W TREE LIGHTS
7	TREE LIGHTS (30-33)	2#12 1-RED, 1-WHITE	20A-120-1P	400W	4-100W TREE LIGHTS
9	GFCI OUTLET	2#12 1-BLACK, 1-WHITE	20A-120-1P	1500W	1-OUTLET
11	GFCI OUTLET	2#12 1-BLACK, 1-WHITE	20A-120-1P	1500W	1-OUTLET
13	GFCI OUTLET	2#12 1-BLACK, 1-WHITE	20A-120-1P	1500W	1-OUTLET
15	GFCI OUTLET	2#12 1-BLACK, 1-WHITE	20A-120-1P	1500W	1-OUTLET
(E) 17	LIGHTING	2#6 RED/BLACK	-	-	EX. LED LUMINAIRES
(E) 19	LIGHTING	2#6 RED/BLACK	-	-	EX. LED LUMINAIRES
(E) 21	IRRIGATION	2#6 RED/BLACK	-	-	EX. IRRIGATION CONTROLLER
23	GFCI OUTLET	2#12 1-BLACK, 1-WHITE	20A-120-1P	1500W	1-OUTLET
25	NOT USED	-	-	-	-
27	NOT USED	-	-	-	-
29	NOT USED	-	-	-	-

SERVICE					
CIRCUIT	TYPE	CONDUCTORS	CIRCUIT BREAKER	LOAD	EQUIPMENT
(E) 2	LIGHTING (19-28)	2#6 RED/BLACK	20A-120-1P	540W	10-54W LED LUMINAIRES
(E) 4	LIGHTING (29-37)	2#6 RED/BLACK	20A-120-1P	486W	9-54W LED LUMINAIRES
(E) 6	LIGHTING (1-10)	2#6 RED/BLACK	20A-120-1P	540W	10-54W LED LUMINAIRES
(E) 8	LIGHTING (11-18)	2#6 RED/BLACK	20A-120-1P	432W	8-54W LED LUMINAIRES
(E) 10	LIGHTING	2#6 RED/BLACK	20A-120-1P	-	PHOTOELECTRIC CONTROL
12	GFCI OUTLET	2#12 1-BLACK, 1-WHITE	20A-120-1P	1500W	1-OUTLET
14	GFCI OUTLET	2#12 1-BLACK, 1-WHITE	20A-120-1P	1500W	1-OUTLET
16	TREE LIGHTS (4-8)	2#12 1-RED, 1-WHITE	20A-120-1P	500W	5-100W TREE LIGHTS
18	TREE LIGHTS (14-17)	2#12 1-RED, 1-WHITE	20A-120-1P	400W	4-100W TREE LIGHTS
20	TREE LIGHTS (18-20, 35)	2#12 1-RED, 1-WHITE	20A-120-1P	300W	3-100W TREE LIGHTS
22	TREE LIGHTS (26-29)	2#12 1-RED, 1-WHITE	20A-120-1P	400W	4-100W TREE LIGHTS
24	GFCI OUTLET	2#12 1-BLACK, 1-WHITE	20A-120-1P	1500W	1-OUTLET
26	GFCI OUTLET	2#12 1-BLACK, 1-WHITE	20A-120-1P	1500W	1-OUTLET
28	GFCI OUTLET	2#12 1-BLACK, 1-WHITE	20A-120-1P	1500W	1-OUTLET
30	NOT USED	-	-	-	-

(E) EXISTING

(E) EXISTING